

# Raspberry Pi Power Over Ethernet (PoE) Adapter Box Assembly Instructions

**WARNING:** To prevent damage to the box locking pins, pull the two halves of the box apart with a gentle rocking motion.

**DO NOT USE EXCESSIVE FORCE**

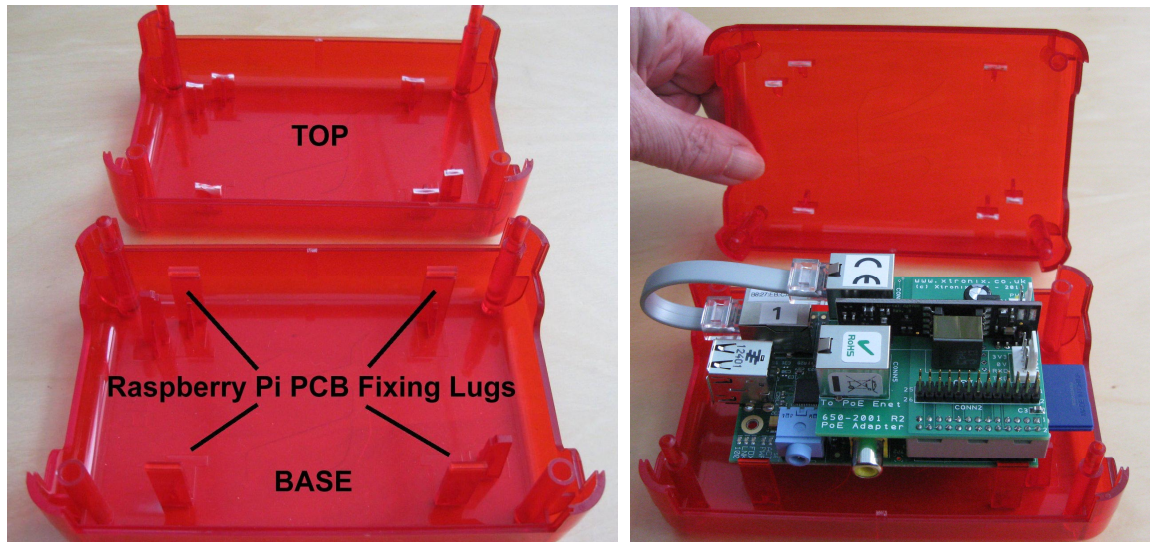

- 1) Carefully pull the box lid from the base using gentle rocking motion. Do not use excessive force as this may damage the box locating pins.

The enclosure is made of two parts, the base and the top. The base has four fixing lugs to hold the Raspberry Pi printed circuit board, the top has these lugs removed.

- 2) Assemble the Xtronix Power over Ethernet adapter to the Raspberry Pi PCB as instructed in the Xtronix Power over Ethernet adapter user manual. Ensure the Adapter PCB is fixed to the Raspberry Pi PCB using the supplied screw and mounting pillar.
- 3) Clip the Raspberry Pi PCB assembly with the PoE adapter above it between the four fixing lugs in the base of the box.
- 4) Plug in any required leads to the Raspberry Pi and the Xtronix Power Over Ethernet Adapter.
- 5) Reassemble the box by lining up the top corner pins with the base corner holes and pushing gently home.

